

# Double Acting High Tonnage Hydraulic Cylinder

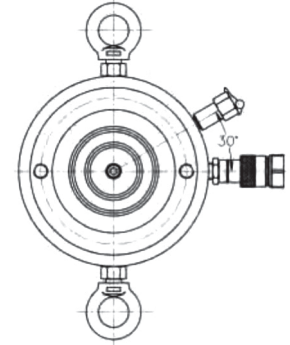

Capacity: 50-800 ton  
Stroke: 50-300 mm  
Max. Pressure: 700 bar

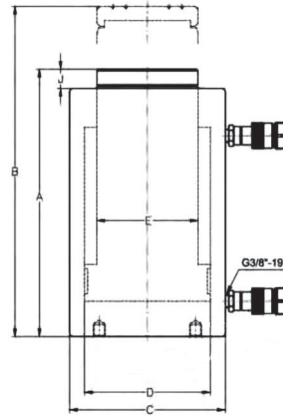

Cylinder Capacity	Stroke	Model Number	Max. Cylinder Capacity		Oil Capacity		Collapsed Height	Extended Height	Outside Dia.	Cylinder Bore Dia.	Plunger Dia.	Weight
			Advance	Retract	Advance	Retract						
ton	(mm)		(KN)		(cm <sup>3</sup> )		A	B	C	D	E	(Kg)
50	50	DHT50-50	500	255	392	200	188	238	140	100	70	21.5
	100	DHT50-100	500	255	784	400	238	338	140	100	70	26
	150	DHT50-150	500	255	1176	600	288	438	140	100	70	31
	200	DHT50-200	500	255	1563	800	338	538	140	100	70	35
	300	DHT50-300	500	255	2352	1200	438	738	140	100	70	44
100	50	DHT100-50	1000	490	770	377	216	266	180	140	100	42
	100	DHT100-100	1000	490	1540	754	266	366	180	140	100	49
	150	DHT100-150	1000	490	2310	1131	316	466	180	140	100	56
	200	DHT100-200	1000	490	3080	1508	366	566	180	140	100	63
	300	DHT100-300	1000	490	4620	2262	466	766	180	140	100	70
150	50	DHT150-50	1390	709	1005	512	224	274	210	160	112	44
	100	DHT150-100	1390	709	2010	1025	274	374	210	160	112	57
	150	DHT150-150	1390	709	3015	1537	324	474	210	160	112	70
	200	DHT150-200	1390	709	4020	2050	374	574	210	160	112	83
	300	DHT150-300	1390	709	6030	3075	474	774	210	160	112	109
200	100	DHT200-100	2000	875	3141	1374	296	396	250	200	150	109
	150	DHT200-150	2000	875	4712	2061	346	496	250	200	150	121
	200	DHT200-200	2000	875	6282	2748	396	596	250	200	150	132
	300	DHT200-300	2000	875	9423	4122	496	796	250	200	150	155
300	100	DHT300-100	3193	1537	4906	2363	327	427	315	250	180	180
	200	DHT300-200	3193	1537	9812	4726	427	627	315	250	180	220
	300	DHT300-300	3193	1537	14718	7089	527	827	315	250	180	260
400	100	DHT400-100	3919	1317	5723	1924	355	455	355	270	220	255
	200	DHT400-200	3919	1317	11446	3848	455	655	355	270	220	310
	300	DHT400-300	3919	1317	17169	5772	555	855	355	270	220	375
500	100	DHT500-100	5000	1948	8038	3133	375	475	395	320	250	326
	200	DHT500-200	5000	1948	16076	6266	475	675	395	320	250	394
	300	DHT500-300	5000	1948	24114	9399	575	875	395	320	250	462
600	100	DHT600-100	6300	2488	10174	4019	436	536	450	360	280	542
	200	DHT600-200	6300	2488	20348	8038	536	736	450	360	280	634
	300	DHT600-300	6300	2488	30522	12057	636	936	450	360	280	726
800	100	DHT800-100	8000	2880	12566	4522	477	577	550	400	320	796
	200	DHT800-200	8000	2880	25132	9044	577	777	550	400	320	944
	300	DHT800-300	8000	2880	37698	13566	677	977	550	400	320	1092